



BERITECH

Solutions Driven by People.



BE-5400 | Dynamic Trimming Lines Enhance Production Precision and Efficiency.

- Optimized production speeds and quality.
- Features an open-frame design for easy cleaning and maintenance.
- Specifically designed and engineered for salmonids.
- Available with hydraulic adjustable platforms.

BE-5400

Advanced Trimming Solutions

The BE-5400 trimming lines are designed to process salmon and trout, ensuring flawless integration into any production environment. Each line can be tailored to meet distinct requirements, providing unmatched

adaptability and efficiency. Designed with ergonomics in mind, our trimming lines feature adjustable working platforms, which can be modified manually or hydraulically, ensuring a comfortable and productive

workspace for operators. Finally, the BE-5400 series is designed with a focus on durability and stability, enabling precise trimming tasks - such as belly cutting, back trimming, or tailing - directly on the conveyor

belt. This design not only improves precision but also efficiency by assigning specific tasks to each operator.

Machine

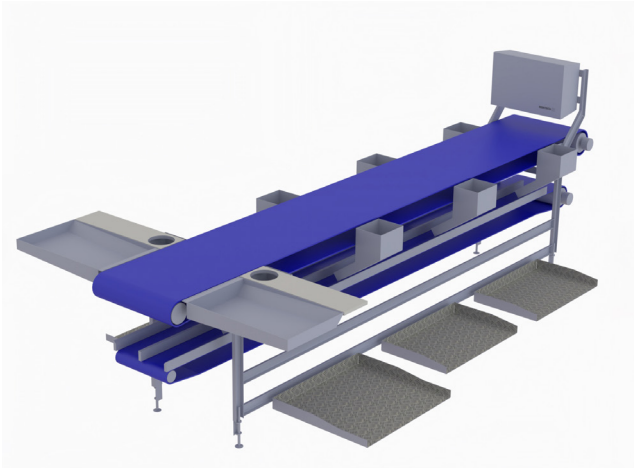

BE-5401 | One-lane Trimming Line

The BE-5401 consists of a conveyor with a modular belt, equipped with 4 to 10 workstations for efficient trimming directly on the belt.

At the beginning of the line, the first two workstations are outfitted with small fillet buffers and manual trimming boards. These are specifically designed for correcting imperfections from the filleting machine and for training new operators.

The system includes a mechanism where the trim is directed into a chute at each station, then collected below on a two-lane trim conveyor that allows for the separation of trimmings.

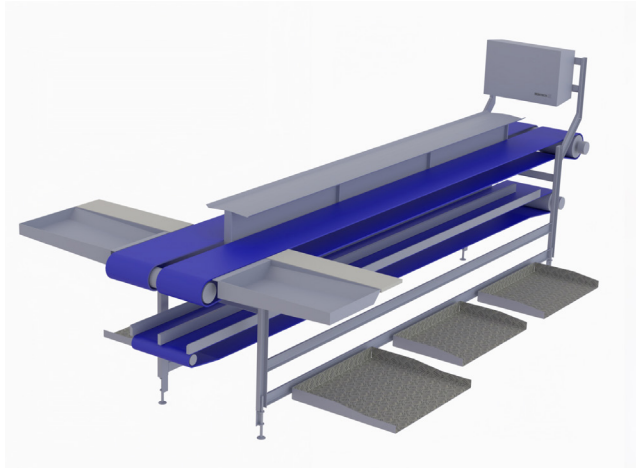

BE-5411 | Two-lane Trimming Line

The BE-5411 features two conveyors with modular belts designed for precise trimming directly on the belt, accommodating 4 to 10 workstations. This two-lane edition is enhanced with a shelf for storing knives and knife sharpeners, promoting efficiency and safety.

At the forefront of the trimming line, the first two workstations are equipped with small fillet buffers and manual trimming boards. Tailored for correcting miscuts from the filleting machine and for the onboarding of new operators, these stations ensure a smooth introduction to the process.

Trim materials are conveniently disposed of in the middle of the line, dropping down to a two-lane trim conveyor situated below. This design facilitates the effective separation of trimmings, maintaining a clean and organized work environment.

Model	BE-5401	BE-5411
Operators	Up to 10 people	Up to 10 people
Power Consumption	0.75 kW	0.75 kW
Electricity	3 x 400V + N + PE /3x220V + PE	3 x 400V + N + PE /3x220V + PE